

**PLAKA dBREAK – ACOUSTICAL
TITAN DOWELS**

Sliding shear dowel with acoustical insulation
REF 12.02.01 - Version V01 - 26/08/2020

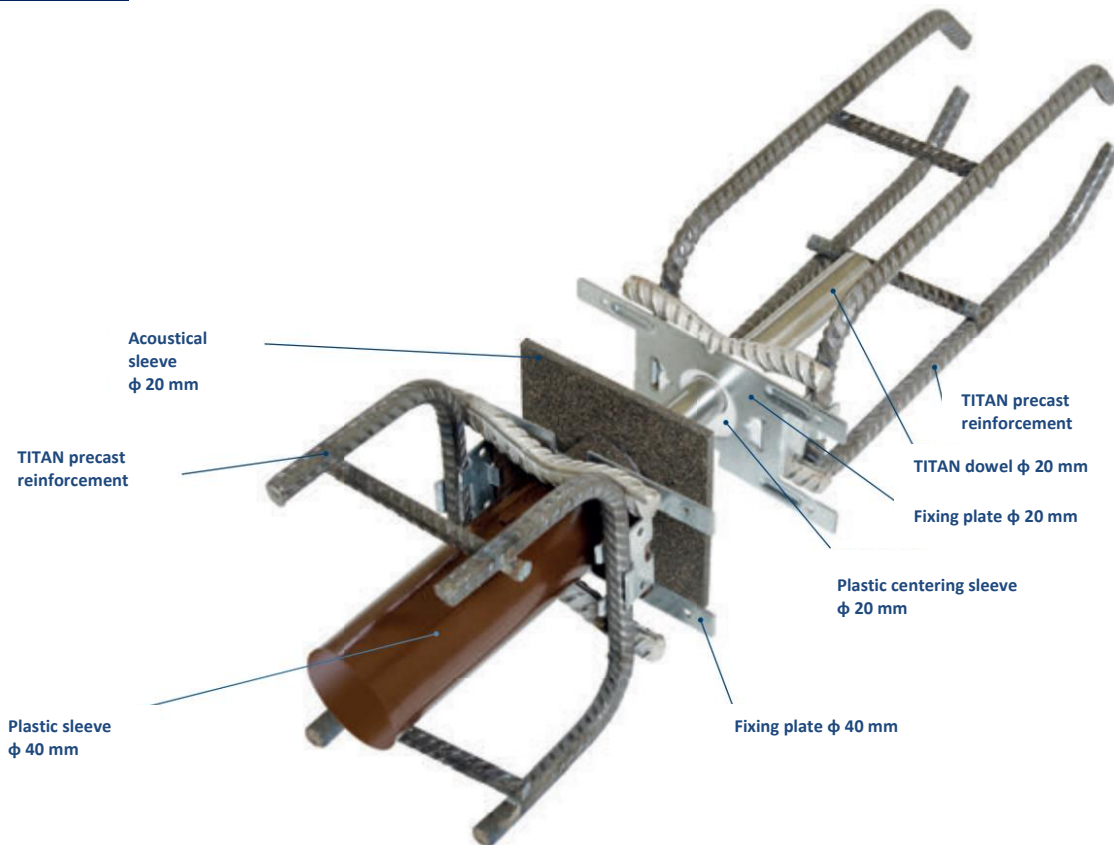

Overview



First concrete pour

| Step 1 –Nail the fixing plate | |
|--|--|
| | <p>Level and secure the formwork at the right position Trace the axes 1 of the dowels on the formwork Nail the fixing plate 3 following the marks 2, the stop 6 being placed at the bottom of the plate.</p> |
| Step 2 –Placement of the sleeve | |

©Copyright protected

This sheet, written with great care, supersedes all previous versions. The technical information on the design, models, illustrations, design values and specifications are believed to be accurate. We make no warranties (expressed or implied) as to its accuracy and assumes no liability in connection with non suitable use of this product. We reserve the right to modify the contents of this form without prior notice.

**PLAKA dBREAK – ACOUSTICAL
TITAN DOWELS**

Sliding shear dowel with acoustical insulation
REF 12.02.01 - Version V01 - 26/08/2020

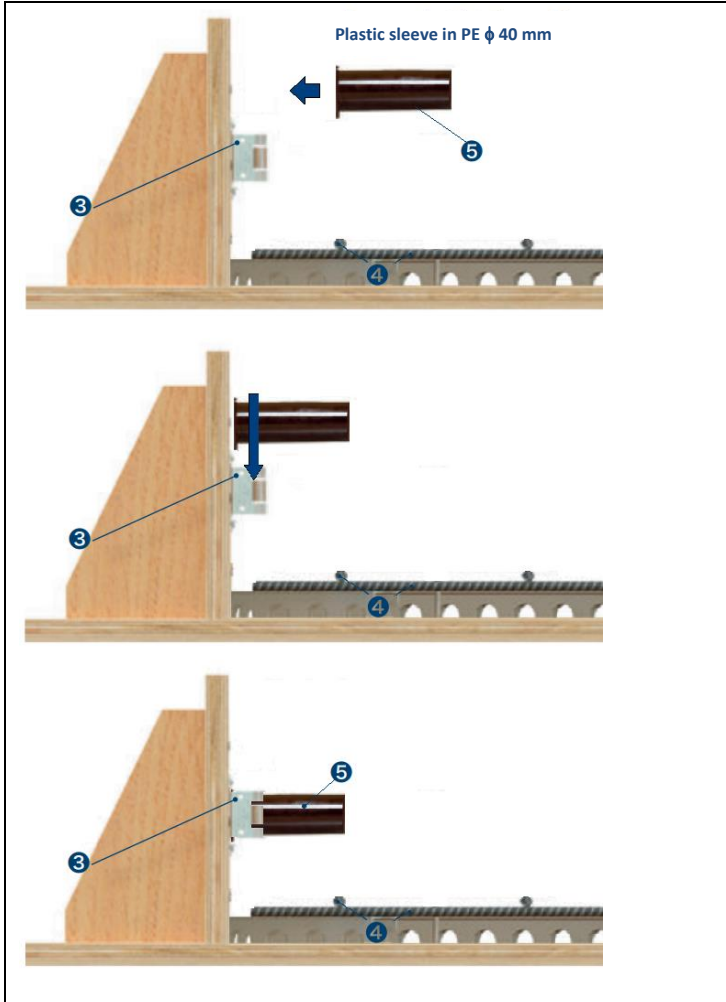

Place the lower reinforcement layer ④ of the first phase concrete structure

Slide the plastic sleeve ⑤ (without removing the label) into the guide of the fixing plate ③, to the stop ⑥

Step 3 – Clip the TITAN precast cage onto the fixing plate

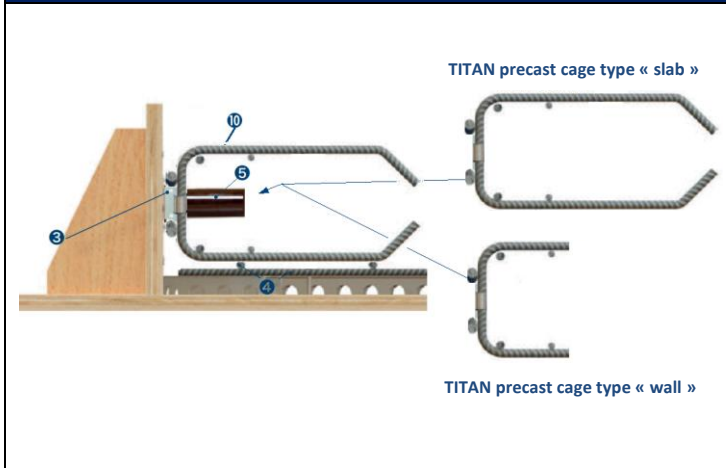

- Clip the TITAN precast reinforcement ⑩ onto the fixing plate ③.
 - In cases where the first concrete pour is a wall or a beam, the TITAN precast reinforcement type « wall » will suit.
 - In cases where the concrete pour is a slab, the TITAN precast reinforcement type « slab » is required.
- Place the other recommended reinforcement (1st phase)
- Pour the first phase concrete.

**PLAKA dBREAK – ACOUSTICAL
TITAN DOWELS**

Sliding shear dowel with acoustical insulation
REF 12.02.01 - Version V01 - 26/08/2020



Second concrete pour

Step 4 – Insertion of the acoustical sleeve into the plastic sleeve

Acoustical sleeve in reinforced cork-rubber

- After hardening of the first phase concrete, remove the timber formwork.
- Insert the acoustical sleeve 7 into the plastic sleeve 5

Step 5 – Placement of the dowel and the accessories of the second phase

- Place the insulation panel 11 (filling of the joint)
- Install the lower reinforcement layer at the other side of the joint (second pour)
- Insert the TITAN dowel 12 fully into the acoustical sleeve
- Clip the TITAN precast reinforcement 10 (together with the centering sleeve 14) on the fixing plate 3 and slide the assembly onto the TITAN dowel 12
- Place the other necessary reinforcement bars of the concrete structure
- Secure the TITAN precast cage to the reinforcement bars and pour the second phase concrete