

**PLAKA – PLAKAFORM**

Permanent formwork for foundation beam, slab, pile head,...  
REF 04.05.02 - Version V01 - 18/12/220x

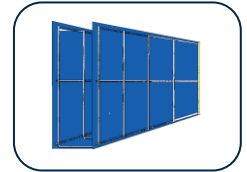

**Description**



Plakaform is a permanent formwork made from reinforced plastic used to form the pile head blocks, foundation beams, foundation footings. These forms are to be placed directly at the bottom of the excavation. The base panel has dimensions of 2.40 x 2.20 m. These panels are cut and folded to size according to the formwork plan. For beams and footings, the elements thus produced have a U-shape. They are always placed with a minimum overlap of 10 cm. Under these conditions, the concrete layer of cleanliness at the bottom of the excavation is not necessary.

**Application fields**

- Disposable formwork for:
- foundation beams
  - slabs
  - pile heads
  - reinforced concrete blocks

**Properties**

Propriétés mécaniques	
Material	Reinforced plastic - steel reinforcing mesh - polyethylene sheet
Reinforcing mesh	Mesh (100mm x 150mm) of the following diameters <ul style="list-style-type: none"> <li>• cross bars: diameter 3.8mm</li> <li>• longitudinal bars: diameter 4.8mm</li> </ul> <p>The steel reinforcements are coated with two heat-sealed polyethylene sheets, resistant to concrete pressure.</p>
Polyethylene sheet	Polyethylene is a plastic material formed mainly by carbon and hydrogen. Non-toxic, it has no effect on drinking water UV stable for 6 months under direct exposure.

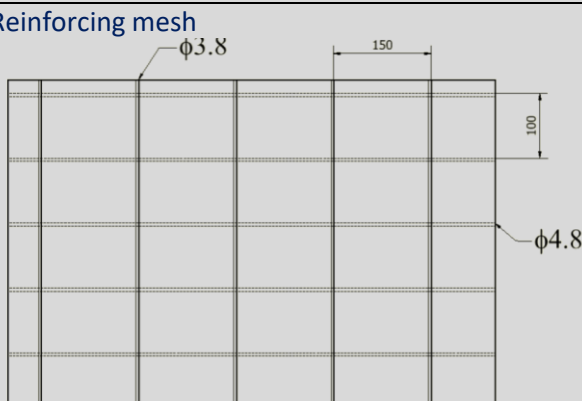

©Copyright protected

This sheet, written with great care, supersedes all previous versions. The technical information on the design, models, illustrations, design values and specifications are believed to be accurate. We make no warranties (expressed or implied) as to its accuracy and assumes no liability in connection with non suitable use of this product. We reserve the right to modify the contents of this form without prior notice.

**PLAKA – PLAKAFORM**

Permanent formwork for foundation beam, slab, pile head,...  
REF 04.05.02 - Version V01 - 18/12/220x

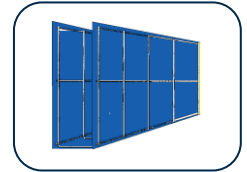

**Dimensions**

Dimensions des matériaux		
Article	Dimensions	Code
Complete plate	2,20 x 2,40m	PESOB
Can be delivered to size (cut + folded according to specifications)		

**Implementation**

After excavation to size, the PLAKAFORM is placed directly at the bottom of the excavation. The reinforcement is placed and maintained at a distance from the formwork by continuous PVC type A spacers, providing a cover of at least 30 mm.



Concrete cover on the sides is provided by conventional concrete or fibrobeton continuous spacers. After that, we backfill on the sides of the foundation, in order to take advantage of the earth stop to balance the concrete pressures during its implementation. After concreting, the PLAKAFORM remains in place to serve as protection for the buried concrete. In case the foundation is not reinforced, special spacers are placed in the formwork.

**Measurement mode**

Use of the PLAKAFORM layout program.  
List of Plakaform elements to be validated by the customer



©Copyright protected

This sheet, written with great care, supersedes all previous versions. The technical information on the design, models, illustrations, design values and specifications are believed to be accurate. We make no warranties (expressed or implied) as to its accuracy and assumes no liability in connection with non suitable use of this product. We reserve the right to modify the contents of this form without prior notice.